

I&GN RR CO.
BLOCK NO. 6
SURVEY NO. 31
ABSTRACT NO. 637

I&GN RR CO.
BLOCK NO. 6
SURVEY NO. 32
ABSTRACT NO. 638

750.000
ACRES

REMAINING PORTION OF A CALLED
3000.00 ACRE TRACT
VOLUME 1899, PAGES 266-270
OFFICIAL PUBLIC RECORDS
+/- 1330.4 ACRES

580.435
ACRES

I&GN RR CO.
BLOCK NO. 6
SURVEY NO. 47
ABSTRACT NO. 653

I&GN RR CO.
BLOCK NO. 6
SURVEY NO. 46
ABSTRACT NO. 652

N 89°48'52" E 6649.03'

N 13°13'10.31" W
N 13°10'16" E 4678.27'

S 00°06'51" W 4551.79'

S 89°48'52" W 7705.95'

EAST 2932.23'

SOUTH 1942.85'

N 89°43'02" W 5208.82'
(N 89°41'55" W 5208.91')

242
S

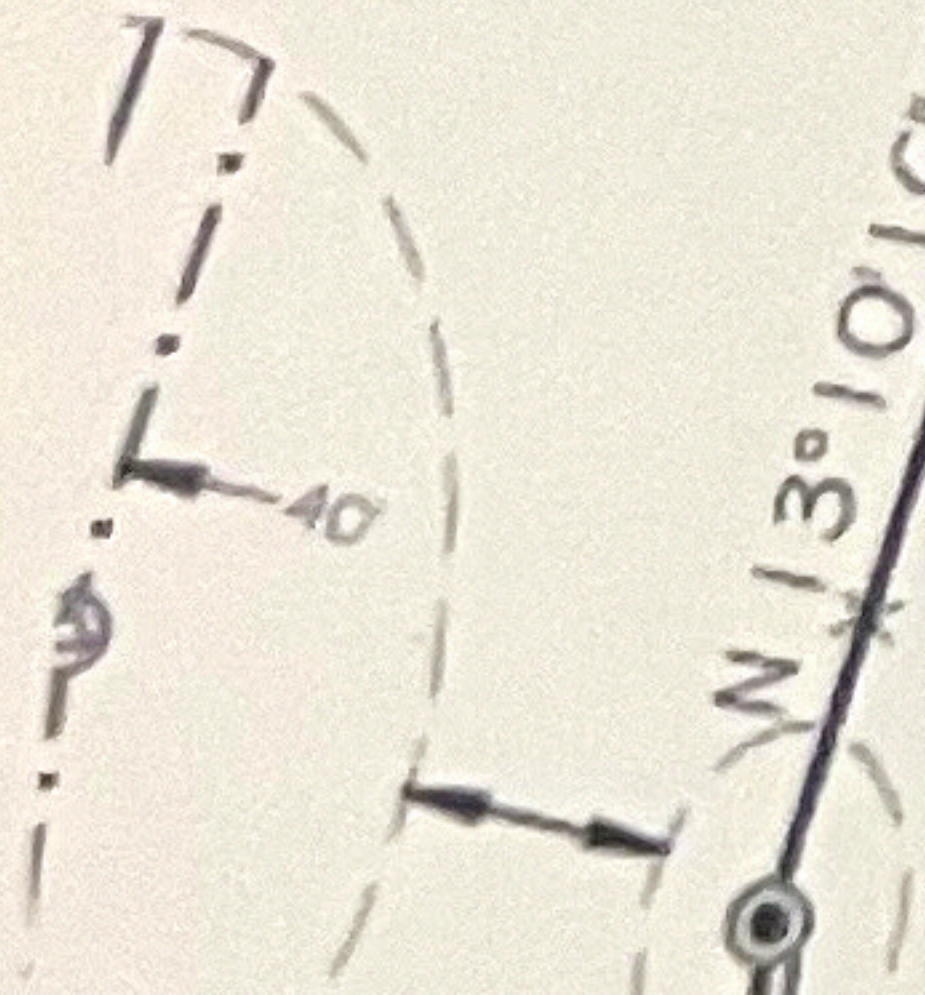

N 13°10'16" E 2056.59'